

Spring-return system

Independent of the workpiece diameter; modular design for extra flexibility



Tool set 421



Product features

- Modular design:
Tool can be used as right-hand and left-hand version
- Modular shank design:
shank size 16 x 16 mm, adaptable
- Top edge of shank = centre height
- Set screws in shank for correcting alignment
- Hardened pin
- Right spring (pre-mounted) for spindle direction M3 (CW), see page 27

Set consisting of

- 1 x base shank (solid shank version) tool 421-16M
- 1 x shank adapter 20 x 20 mm
- 1 x shank adapter 25 x 25 mm
- 1 x spring, left (for changing the direction of rotation)
- In high-quality case

TOOL SET

Order no.	Tool holder designation	Dimension [mm]						
		a	b	c	d	e	f	x
31002844	421-16M250606	16	16	112.5	25	32.5	28.5	2.5
	With shank adapter 20 x 20 mm	20	20	112.5	25	32.5	32.5	2.5
	With shank adapter 25 x 25 mm	25	25	112.5	25	32.5	37.5	2.5

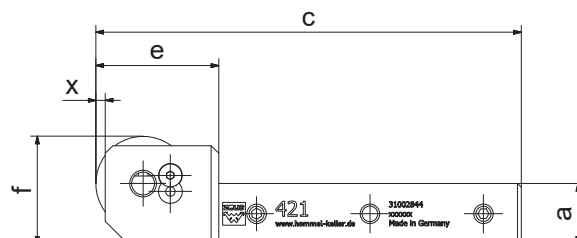

E-KIT

Order no.	Direction	
21BHR1503	right	
21BHR1504	left	

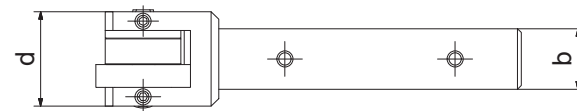

Marking roll n° 41



Benefits

- Especially versatile since it is independent of the workpiece diameter
- Marking is possible at high speed
- Change of the reading direction is possible (see operating manual)

Application

- Precise positioning of characters on workpiece circumference
- Centre height corresponds to the first marking point
- Marking positions can be set as desired

Features

- The design of marking roll n° 41 is independent of the workpiece diameter
- Three driving points guarantee a perfect impression. They may be placed to the side of the characters
- Full depth and definition are accomplished in one go
- All characters can be used as a drive, e.g. logos, backslash, asterisks, number signs, etc.

Standard design		For marking tools
Flank angle	90°	421
Dimensions (Ø x width x bore) [mm]	25 x 6 x 6	
Typeface	According to DIN 1451	
Max. character height	See "Technology" starting on page 20	