

How To Use This Catalog

Welcome To The RSVP Tooling Interactive Catalog Section

Clickable & Touch Links

Within each page we have included a wide range of links that can be click when viewed on a computer or touched on a smart device (phones and pads).

The side tabs to the left when click will return you to the section index.

On the master index and section indexes the line items also contain links to the indicated pages.

Tangential Index	70
Attachments.....	71
Thread Rolls & Setting Angles.....	72
Design of Rolls	73
RT10 - RT20 - RT30 Overview & Components....	74 - 75
Tangential Charts	76 - 77

Downloading this catalog to a smart device - phones or pads

This catalog can be viewed on smart devices such as phones and pads. Most free PDF viewers will allow you to flip from page to page.



However, if you would like to take advantage of the built in interactive features you will need to download an app.



We have reviewed many apps and have found that “ezPDF Reader” seems to work the best on both the Apple and Droid product lines. It is available in two forms - one for the pads and one for the phones.

Start by going to your apps download center on your device. Search for “ezPDF Reader” and look for the above icon. Purchase the app that matches your device (at the time this catalog was created ezPDF reader was selling for \$2.99). Download and activate the app.

To download the RSVP Tooling Catalog follow the “ezPDF Reader” instructions to download a file from the internet to the app. On the home screen of “ezPDF Reader” select “URL Download” and enter the following URL - “http://www.rsvptooling.com/RSVPcatalog.pdf”. Once the catalog is loaded to “ezPDF Reader” you can start using the interactive features.

Icon Links



Click this icon to follow and like RSVP Tooling on Facebook. Get the most up-to-date information on products, training, videos and products for your smart devices.



Click this icon to follow our short RSVP tweets. Quick tips and helpful links to increase your threading quality and productivity.



Click this icon to expand your network of professional contacts.



Click this icon to visit our video channel. When this icon is next to a product you can directly link to a demonstration video.



Click this icon to quickly access our extensive knowledge base within the RSVP Tooling website.



This icon is not active within this PDF.



Click this icon to return to the section index for that product or page.



Radial Thread Rolling

Radial

RSVP Radial rolling heads offer an ideal solution for producing very short threads with tight runout, rolling close to a shoulder or into an undercut. Due to the 3-roll action of the radial system, the component is well supported during the rolling process, even when threading the ends of long shafts. Since the rolling action is completed within one revolution of the rolls, cycle times are extremely short and in most cases, under 0.5 seconds.

Radial rolling heads are automatically reset after each threading pass. They are actuated by external means when positioned over the component to be rolled by use of the external trip lever on stationary heads, or an internal push rod on rotating heads.

Operation	68
RE-8	69
RE-10	70
RE-13	71
RE-16	72
RE-23	73



Radial Thread Rolling

The Radial Rolling Operation

Unlike the axial and tangential rolling systems, radial rolling does not require a controlled feed motion in order to produce a thread.

The RSVP RE style rolling head simply needs to be positioned over the part using the forward stroke of the machine. This may be a standard turret lathe, CNC machine or rotary transfer machine.

When the head is in position, the trip lever is actuated and the rolling process begins (fig. 2). The external trip can only be actuated when the head is stationary. For applications where the head is revolving, an internal trip must be actuated by a push rod mechanism through the shank (or flange) of the head.

The tripping of the head causes all 3 rolls to rotate under spring pressure until they contact the blank. At this point they pinch up against the part, and are driven round one full revolution. During this rotation of the rolls, their geometry effects a "squeezing down" in a radial direction and the thread is rapidly formed (fig. 3).

Once the rolls have completed the threading cycle, they are returned to the start position with their flats facing the threaded part. This allows the head to be retracted without damage to the thread. The head is now re-set and ready for the next cycle (fig. 4).

It is not advisable to trip the head without a blank in position as the rolls would not return to their start point. If a rolling pass is then attempted, the rolls will hit against the blank, damaging the rolls and possibly the head.

In automatic, un-manned cycles, it is advisable to operate some means of checking device, to ensure that the head is in the reset position before any attempt is made to roll a thread.

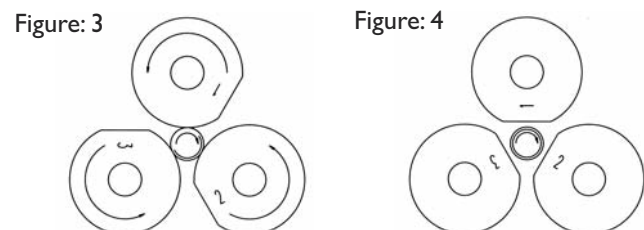
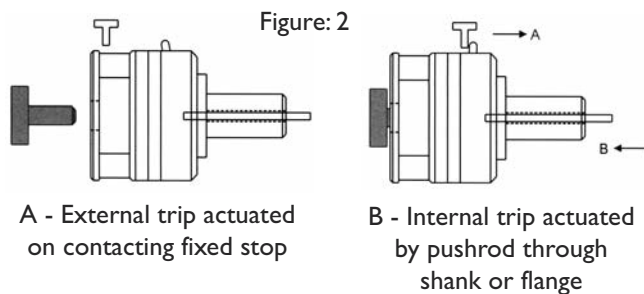

The external trip lever can be actuated automatically or by hand. For manual operation, a ball type handle can be attached to the trip lever which accepts an M5 x 0.8 thread. For automatic tripping, it is required that the external lever is brought up against a machine stop precisely at the point when the head reaches the desired rolling position. The head must not still be advancing forward after it is tripped.

Rotating direction of spindle

Most conventional spindles run in a right-hand, or clockwise direction, so RE radial heads and rolls are primarily supplied for this condition. These standard, right hand heads should not be solely associated with right hand threads. Right and left hand threads can be produced on the same head; it is only the roll design that alters.

The standard shank style heads illustrated in this publication can be mounted in most lathe turrets and used stationary, in which case the component & spindle rotate in the conventional right hand direction.

When used in rotating mode, RSVP radial heads can be shank or flange mounted. The heads must then be tripped by an internal push rod that passes through the back of the head. Actuation is normally by mechanical, hydraulic or pneumatic means.

Clamping of the component

The radial rolling action is completed in one revolution of the rolls which requires high momentary torque. This in turn imparts high loads on the part being rolled. It is imperative the work holding system is able to resist these high forces, and hydraulic clamping is usually preferred.

Blank preparation

Ensuring the blank diameter is correct is an essential ingredient for trouble free thread rolling. As with other rolling methods, the blank diameter is initially set at or just below the pitch diameter of the thread. Successive rolling passes will then determine the best blank size by trial and error. Threads rolled by the radial method should not exhibit smooth, fully formed crests as this indicates over-rolling which will shorten roll life.

Safety

Radial thread rolling combines high spindle speeds with extremely fast cycle times. Machinery should always be adequately guarded. If RSVP radial heads are to be fitted to manually operated lathes, then full eye protection should always be worn.

Radial Thread Rolling

RE-8 - Radial Head

RADIAL THREAD ROLLING HEADS

STANDARD SHANK STYLE ILLUSTRATED
FLANGE MOUNTING ALSO AVAILABLE

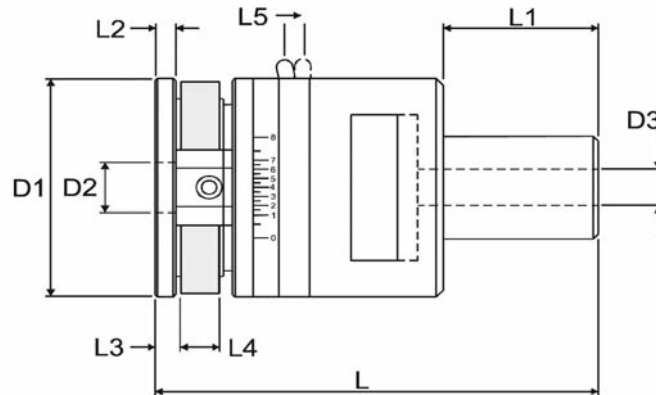

L4 = Maximum width of rolls

L5 = Stroke to trip head

Dimensions

SHANK Ø OPTIONS		D1	D2	D3	L	L1	L2	L3	L4max	L5
3/4 - 1 - 1,1/4	inches	2.520	0.591	0.413	4.551	1.575	0.197	0.205	0.457	0.087
20 - 25 - 30	mm	64	15.0	10.5	115.6	40.0	5	5.2	11.6	2.2

The following thread rolls may be ordered as standard on the RE-8 head

ISO Metric

Nominal Size x Pitch mm

M 3 x 0.5
M 3.5 x 0.6
M 4 x 0.7
M 4 x 0.5
M 5 x 0.8
M 5 x 0.5
M 6 x 1
M 6 x 0.75
M 6 x 0.5
M 8 x 1.25
M 8 x 1.25
M 8 x 0.75
M 8 x 0.5
M 10 x 1.5
M 10 x 1.25
M 10 x 1
M 10 x 0.75

Metric Taper

Nominal Size x Pitch mm

M 5 x 0.8
M 6 x 1
M 8 x 1
M 10 x 1

Unified

Nominal Size x TPI

5 x 40 UNC
5 x 44 UNF
6 x 32 UNC
6 x 40 UNF
8 x 32 UNC
8 x 36 UNF
10 x 24 UNC
10 x 32 UNF
12 x 24 UNC
12 x 28 UNF
1/4 x 20 UNC
1/4 x 28 UNF
1/4 x 32 UNEF
5/16 x 18 UNC
5/16 x 24 UNF
5/16 x 32 UNEF
3/8 x 16 UNC
3/8 x 24 UNF
3/8 x 32 UNEF

The range of sizes shown can normally be safely rolled on the RE-8 head. For thread forms other than those listed, please contact our technical department.

Whitworth

Nominal Size x TPI

1/8 x 40 BSW
3/16 x 24 BSW
3/16 x 32 BSF
1/4 x 20 BSW
1/4 x 26 SF
5/16 x 18 BSW
5/16 x 22 BSF
3/8 x 16 SW
3/8 x 20 BSF

Whitworth Pipe BSP

Nominal Size x TPI

G 1/8 x 28

Whitworth Pipe BSPT

Nominal Size x TPI

R 1/8 x 28

American Pipe Taper

Nominal Size x TPI

1/16 x 27 NPT
1/8 x 27 NPT

American Pipe Dry-Seal

Nominal Size x TPI

1/16 x 27 NPTF
1/8 x 27 NPTF

Thread rolls are supplied as standard to suit right hand heads. This refers to the direction of rotation of the spindle and not the thread itself. Both right and left hand threads can be rolled using the same head; only the rolls are changed.

Radial Thread Rolling

RE-10 - Radial Head

RADIAL THREAD ROLLING HEADS

STANDARD SHANK STYLE ILLUSTRATED
FLANGE MOUNTING ALSO AVAILABLE

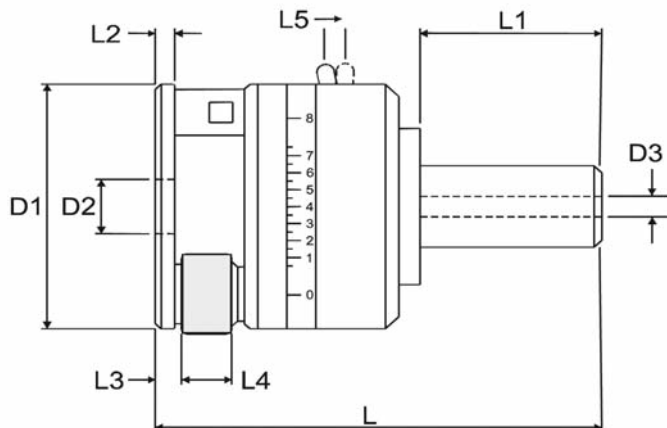

L4 = Maximum width of rolls
L5 = Stroke to trip head

Dimensions

SHANK Ø OPTIONS		D1	D2	D3	L	L1	L2	L3	L4max	L5
3/4 - 1 - 1,1/4	inches	3.937	1.024	0.492	6.480	2.362	0.236	0.244	0.772	0.138
20 - 25 - 30 - 32	mm	100	26.0	12.5	164.6	60.0	6	6.2	20	3.5

The following thread rolls may be ordered as standard on the RE-10 head

ISO Metric

Nominal Size x Pitch mm

M 8 x 0.75
M 8 x 1
M 8 x 1.25
M 10 x 1
M 10 x 1.25
M 10 x 1.5
M 12 x 1
M 12 x 1.25
M 12 x 1.5
M 14 x 1
M 14 x 1.25
M 14 x 1.5

Unified

Nominal Size x TPI

5/16 x 20 UN
5/16 x 24 UNF
5/16 x 32 UNEF
3/8 x 16 UNC
3/8 x 24 UNF
3/8 x 32 UNEF
7/16 x 20 UNF
7/16 x 28 UNEF
1/2 x 20 UNF
1/2 x 28 UNEF
9/16 x 18 UNF
9/16 x 20 UN
9/16 x 24 UNEF

Whitworth Pipe BSP

Nominal Size x TPI

G 1/8 x 28
G 1/4 x 19

Whitworth Pipe BSPT

Nominal Size x TPI

R 1/8 x 28 R1/4x19

American Pipe Taper

Nominal Size x TPI

1/16 x 27 NPT
1/8 x 27 NPT
1/4 x 18 NPT

Metric Taper

Nominal Size x Pitch mm

M 8 x 1
M 10 x 1
M 12 x 1
M 10 x 1.25
M 12 x 1.25
M 12 x 1.5
M 14 x 1.5

Whitworth

Nominal Size x TPI

5/16 x 22 BSF
3/8 x 20 BSF
7/16 x 18 BSF
1/2 x 16 BSF
9/16 x 16 BSF
5/16 x 18 BSW
3/8 x 16 BSW

American Pipe Dry-Seal

Nominal Size x TPI

1/16 x 27 NPTF
1/8 x 27 NPTF
1/4 x 18 NPTF

The range of sizes shown can normally be safely rolled on the RE-10 head. For thread forms other than those listed, please contact our technical department.

Thread rolls are supplied as standard to suit right hand heads. This refers to the direction of rotation of the spindle and not the thread itself. Both right and left hand threads can be rolled using the same head; only the rolls are changed.



Radial Thread Rolling

RE-13 - Radial Head

RADIAL THREAD ROLLING HEADS

STANDARD SHANK STYLE ILLUSTRATED
FLANGE MOUNTING ALSO AVAILABLE

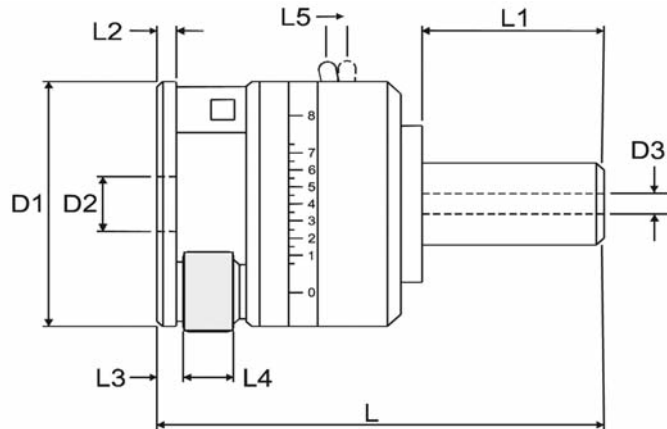

L4 = Maximum width of rolls

L5 = Stroke to trip head

Dimensions

SHANK Ø OPTIONS		D1	D2	D3	L	L1	L2	L3	L4max	L5
1, 1/4 - 1, 1/2	inches	4.921	1.260	0.492	7.622	3.150	0.315	0.323	0.968	0.118
30 - 40	mm	125	32.0	12.5	193.6	80.0	8	8.2	24.6	3

The following thread rolls may be ordered as standard on the RE-13 head

ISO Metric

Nominal Size x Pitch mm

M 10 x 0.75
M 10 x 1
M 10 x 1.25
M 10 x 1.5
M 12 x 1
M 12 x 1.25
M 12 x 1.5
M 12 x 1.75
M 14 x 1
M 14 x 1.25
M 14 x 1.5
M 16 x 1
M 16 x 1.5
M 18 x 1
M 18 x 1.5

Metric Taper

Nominal Size x Pitch mm

M 10 x 1
M 12 x 1
M 10 x 1.25
M 12 x 1.25
M 12 x 1.5
M 14 x 1.5
M 16 x 1.5
M 18 x 1.5

Unified

Nominal Size x TPI

7/16 x 14 UNC
7/16 x 20 UNF
7/16 x 28 UNEF
1/2 x 13 UNC
1/2 x 20 UNF
1/2 x 28 UNEF
9/16 x 18 UNF
9/16 x 20 UN
9/16 x 24 UNEF
5/8 x 18 UNF
5/8 x 24 UNEF
11/16 x 24 UNEF

Whitworth

Nominal Size x TPI

7/16 x 18 BSF
1/2 x 16 BSF
9/16 x 16 BSF
7/16 x 14 BSW
1/2 x 12 BSW

Whitworth Pipe BSP

Nominal Size x TPI

G 1/8 x 28
G 1/4 x 19
G 3/8 x 19

Whitworth Pipe BSPT

Nominal Size x TPI

R 1/8 x 28
R 1/4 x 19
R 3/8 x 19

American Pipe Taper

Nominal Size x TPI

1/8 x 27 NPT
1/4 x 18 NPT
3/8 x 18 NPT

American Pipe Dry-Seal

Nominal Size x TPI

1/8 x 27 NPTF
1/4 x 18 NPTF
3/8 x 18 NPTF

The range of sizes shown can normally be safely rolled on the RE-13 head. For thread forms other than those listed, please contact our technical department.

Thread rolls are supplied as standard to suit right hand heads. This refers to the direction of rotation of the spindle and not the thread itself. Both right and left hand threads can be rolled using the same head; only the rolls are changed.



Radial Thread Rolling

RE-16 - Radial Head

RADIAL THREAD ROLLING HEADS

STANDARD SHANK STYLE ILLUSTRATED
FLANGE MOUNTING ALSO AVAILABLE

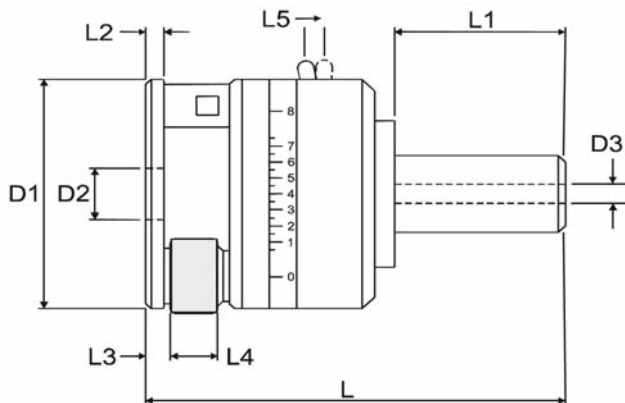

L4 = Maximum width of rolls
L5 = Stroke to trip head

Dimensions

SHANK Ø OPTIONS		D1	D2	D3	L	L1	L2	L3	L4max	L5
1, 1/2 - 2	inches	5.512	1.594	0.492	8.366	3.150	0.394	0.402	1.165	0.173
40 - 50	mm	140	40.5	12.5	212.5	80.0	10	10.2	29.6	4.4

The following thread rolls may be ordered as standard on the RE-16 head

ISO Metric

Nominal Size x Pitch mm

M 12 x 1
M 12 x 1.25
M 12 x 1.5
M 12 x 1.75
M 14 x 1
M 14 x 1.25
M 14 x 1.5
M 14 x 2
M 16 x 1
M 16 x 1.5
M 16 x 2
M 18 x 1
M 18 x 1.5
M 18 x 2
M 20 x 1
M 20 x 1.5
M 20 x 2
M 22 x 1
M 22 x 1.5
M 22 x 2

Metric Taper

Nominal Size x Pitch mm

M 12 x 1
M 12 x 1.25
M 12 x 1.5
M 14 x 1.5
M 16 x 1.5
M 18 x 1.5
M 20 x 1.5
M 22 x 1.5

Unified

Nominal Size x TPI

1/2 x 13 UNC
1/2 x 20 UNF
1/2 x 28 UNEF
9/16 x 12 UNC
9/16 x 18 UNF
9/16 x 20 UN
9/16 x 24 UNEF
5/8 x 11 UNC
5/8 x 18 UNF
5/8 x 24 UNEF
11/16 x 24 UNEF
3/4 x 16 UNF
3/4 x 20 UNEF
13/16 x 20 UNEF
7/8 x 14 UNF
7/8 x 20 UNEF

Whitworth

Nominal Size x TPI

1/2 x 16 BSF
9/16 x 16 BSF
5/8 x 14 BSF
1/2 x 12 BSW
9/16 x 12 BSW
5/8 x 11 BSW

Whitworth Pipe BSP

Nominal Size x TPI

G 1/4 x 19
G 3/8 x 19
G 1/2 x 14

Whitworth Pipe BSPT

Nominal Size x TPI

R 1/4 x 19
R 3/8 x 19
R 1/2 x 14

American Pipe Taper

Nominal Size x TPI

1/4 x 18 NPT
3/8 x 18 NPT
1/2 x 14 NPT

American Pipe Dry-Seal

Nominal Size x TPI

1/4 x 18 NPTF
3/8 x 18 NPTF
1/2 x 14 NPTF

The range of sizes shown can normally be safely rolled on the RE-16 head. For thread forms other than those listed, please contact our technical department.

Thread rolls are supplied as standard to suit right hand heads. This refers to the direction of rotation of the spindle and not the thread itself. Both right and left hand threads can be rolled using the same head; only the rolls are changed.



Radial Thread Rolling

RE-23 - Radial Head

RADIAL THREAD ROLLING HEADS

STANDARD SHANK STYLE ILLUSTRATED
FLANGE MOUNTING ALSO AVAILABLE

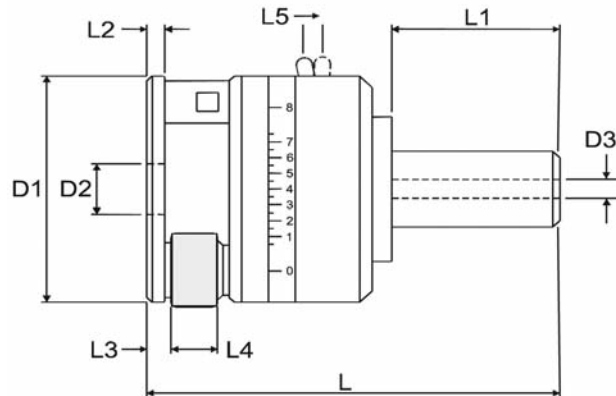

L4 = Maximum width of rolls
L5 = Stroke to trip head

Dimensions

SHANK Ø OPTIONS		D1	D2	D3	L	L1	L2	L3	L4max	L5
2 - 2,1/2	inches	6.693	1.968	0.492	10.295	3.937	0.512	0.520	1.362	0.177
50 - 60	mm	170	50.0	12.5	261.5	100.0	13	13.2	34.6	4.5

The following thread rolls may be ordered as standard on the RE-23 head

ISO Metric

Nominal Size x Pitch mm

M 16 x 1
M 16 x 1.5
M 16 x 2
M 18 x 1
M 18 x 1.25
M 18 x 1.5
M 18 x 2
M 18 x 2.5
M 20 x 1
M 20 x 1.5
M 20 x 2
M 20 x 2.5
M 22 x 1
M 22 x 1.5
M 22 x 2
M 22 x 2.5
M 24 x 1
M 24 x 1.5
M 24 x 2
M 26 x 1.5
M 27 x 2
M 27 x 1.5
M 28 x 1.2
M 30 x 2
M 30 x 1.5

Metric Taper

Nominal Size x Pitch mm

M 16 x 1.5
M 18 x 1.5
M 20 x 1.5
M 22 x 1.5
M 24 x 1.5
M 26 x 1.5
M 27 x 1.5
M 30 x 1.5

Unified

Nominal Size x TPI

5/8 x 11 UNC
5/8 x 18 UNF
5/8 x 24 UNEF
11/16 x 24 UNEF
3/4 x 10 UNC
3/4 x 16 UNF
3/4 x 20 UNEF
13/16 x 20 UNEF
7/8 x 14 UNC
7/8 x 20 UNEF
15/16 x 20 UNEF
1 x 12 UNF
1 x 20 UNEF
1,1/6 x 18 UNEF
1,1/8 x 12 UNF
1,1/8 x 18 UNEF
1,3/16 x 18 UNEF

Whitworth

Nominal Size x TPI

5/8 x 14 BSF
3/4 x 12 BSF
7/8 x 11 BSF
5/8 x 11 BSW
3/4 x 10 SW

Whitworth Pipe BSP

Nominal Size x TPI

G 3/8 x 19
G 1/2 x 14
G 3/4 x 14

Whitworth Pipe BSPT

Nominal Size x TPI

R 3/8 x 19
R 1/2 x 14
R 3/4 x 14

American Pipe Taper

Nominal Size x TPI

3/8 x 18 NPT
1/2 x 14 NPT
3/4 x 14 NPT

American Pipe Dry-Seal

Nominal Size x TPI

3/8 x 18 NPTF
1/2 x 14 NPTF
3/4 x 14 NPTF

The range of sizes shown can normally be safely rolled on the RE-23 head. For thread forms other than those listed, please contact our technical department.

Thread rolls are supplied as standard to suit right hand heads. This refers to the direction of rotation of the spindle and not the thread itself. Both right and left hand threads can be rolled using the same head; only the rolls are changed.